

DSA30-98 TP SEAL REPLACEMENT

QTY	PART NUMBER	DESCRIPTION
1	KAWASKAKI BAS30-98 BODY	PUMP
1	HUB-10	SPACER
1	SEAL PLATE 11	THRUST PLATE
2	HUB PLATE-12	SEAL PLATE
2	FS34503	SEAL
4	HUB SCREW 15	HUB SCREW
1	KEY DRIVE-16	DRIVE KEY

SEAL PRESS

QTY	PART NUMBER	DESCRIPTION
1	SEAL TOOL ID	SEAL ID PIN
1	SEAL TOOL OD	SEAL OD PRESS

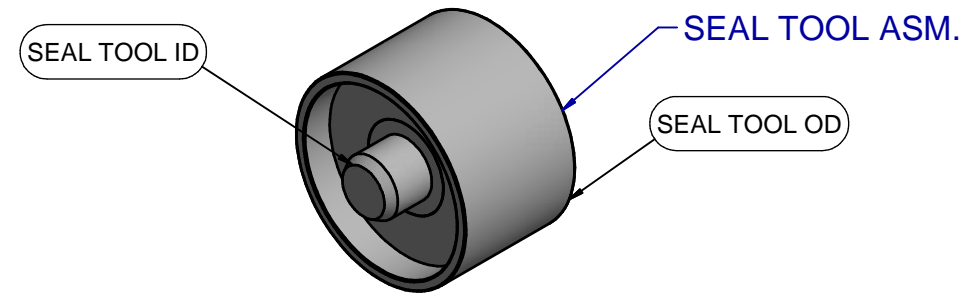
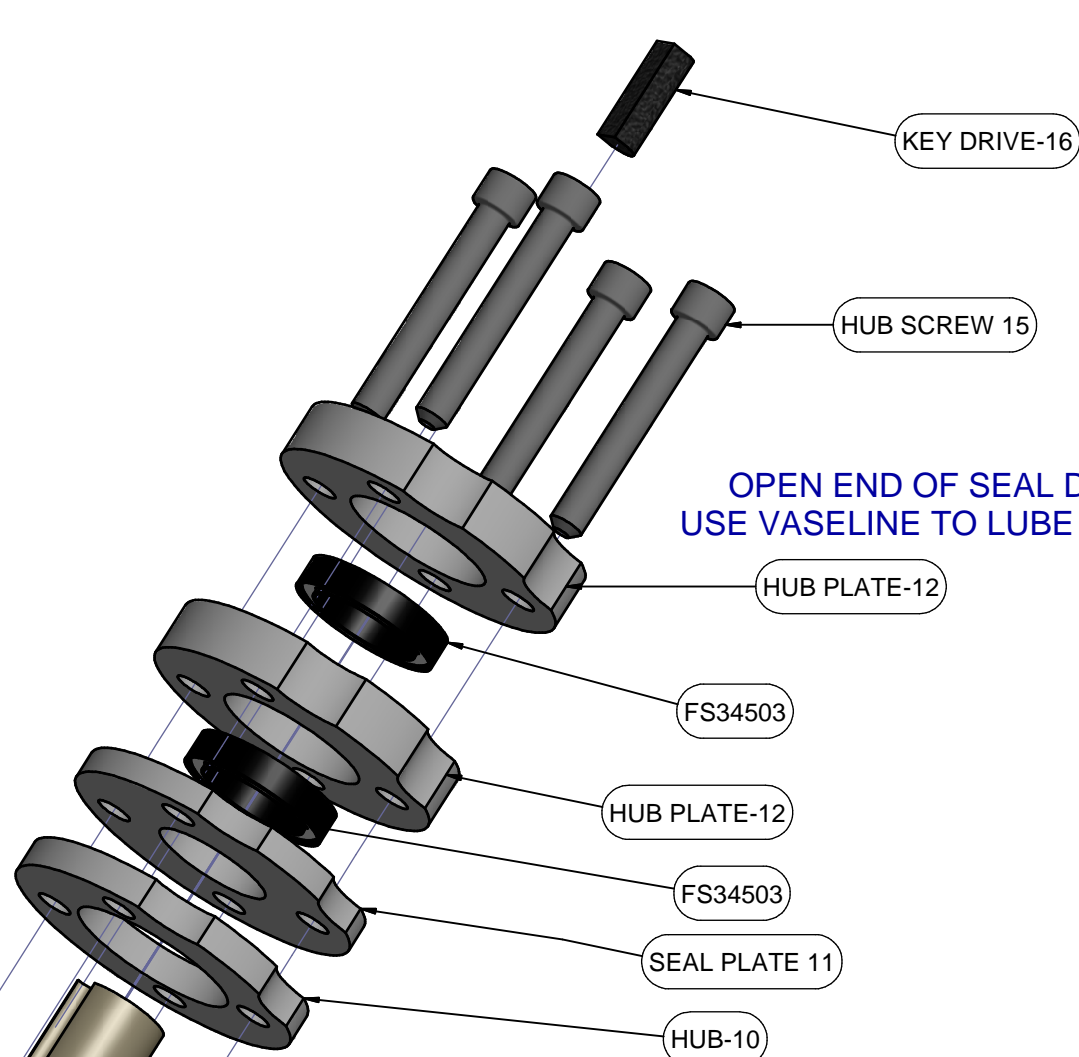
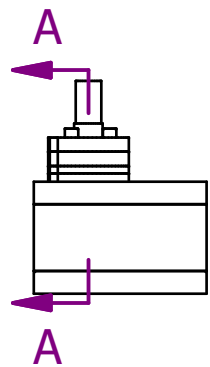

OPEN END OF SEAL DOWN
USE VASELINE TO LUBE SEAL

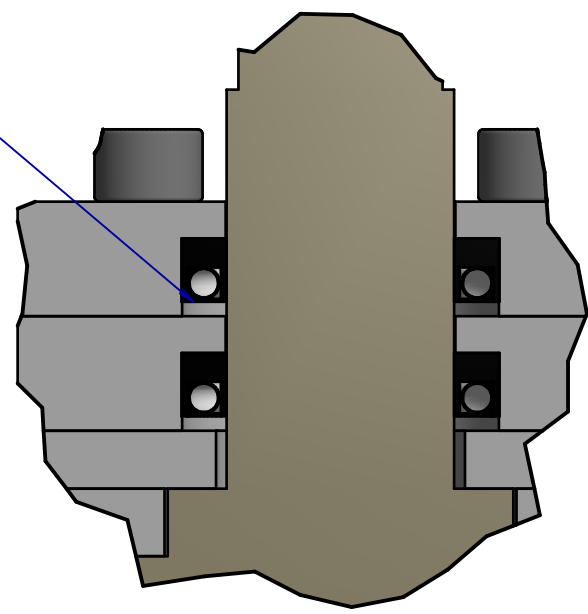

DETAIL B
SCALE 1.50 : 1

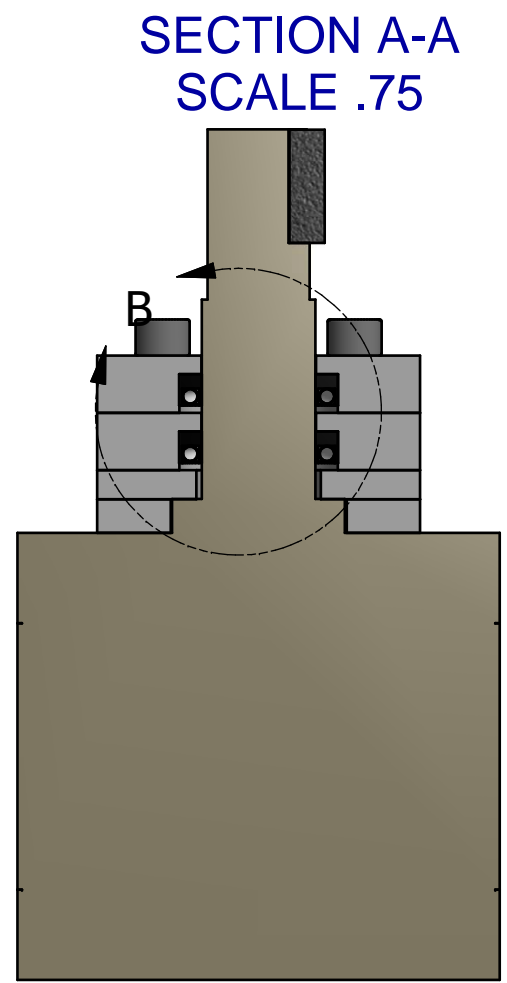

SECTION A-A
SCALE .75

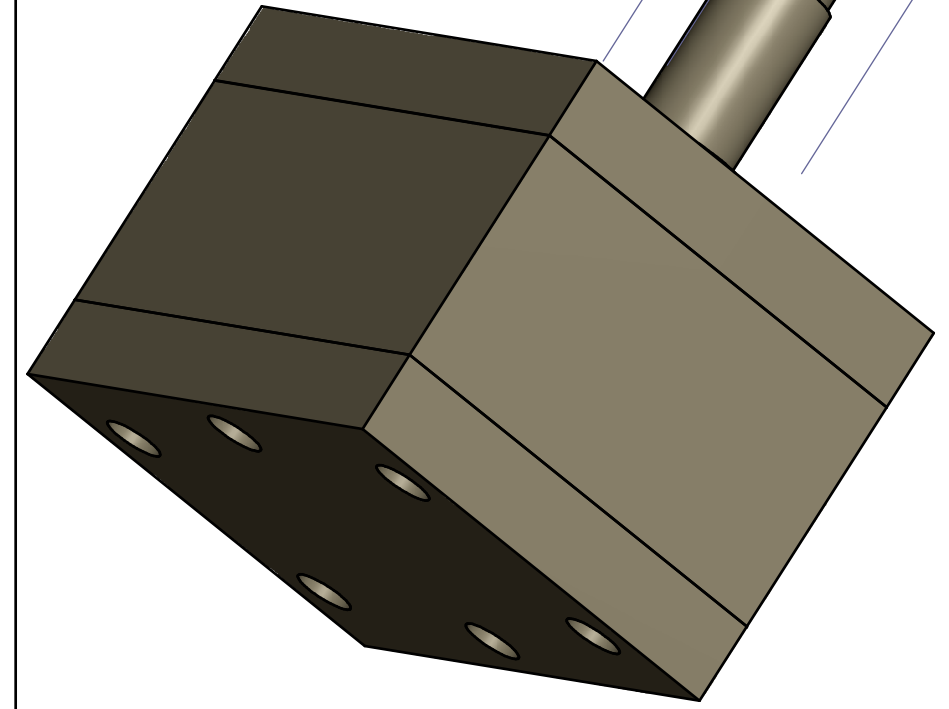

<p>TOLERANCES: UNLESS OTHERWISE SPECIFIED</p> <p>.X = ± 0.1 .XXX = ± 0.005 .XX = ± 0.02 .XXXX = ± 0.0005 ANGULAR ± 1°</p>	<p>REMOVE ALL BURRS & SHARP EDGES SAND RADIUS ALL CORNERS (1/8"-1/4") UNLESS NOTED ALL DIMENSIONS ARE IN INCHES UNLESS OTHERWISE SPECIFIED.</p>	<p>DESIGNED BY: NJD DRAWN BY: NJD DRAWN DATE: 10/24/2013</p>	<p>ERDMAN Automation Corp. 1603 So. 14th Street, Princeton, MN 55371</p>
	<p>DO NOT SCALE THIS DRAWING</p>	<p>PART NAME: BAS30-98-TP</p>	
<p>CONFIDENTIAL - THE INFORMATION IN THIS DOCUMENT IS STRICTLY PROPRIETARY TO ERDMAN AUTOMATION CORP. AND MAY NOT BE DISCLOSED TO NON-EMPLOYEES OF THE COMPANY WITHOUT THE EXPRESS WRITTEN CONSENT OF ERDMAN AUTOMATION CORP. UNAUTHORIZED USE, REPRODUCTION, DISCLOSURE, OR RETENTION OF ANY INFORMATION CONTAINED HEREIN IS EXPRESSLY PROHIBITED. ALL PATENT, COPYRIGHT, AND MANUFACTURING RIGHTS ARE RESERVED. COPYRIGHT ERDMAN AUTOMATION CORPORATION ALL RIGHTS RESERVED</p>		<p>FINISH: MATERIAL:</p>	<p>REV: PART #: BAS30-98-TP</p>
<p>DRAWING SIZE B</p>	<p>SHEET: 1 OF 1</p>	<p>USED IN:</p>	