

Teflon Valve Cartridge Kit Replacement Instructions

PARTS LIST		
PART NUMBER	QTY	DESCRIPTION
3842A26	1	COMBINATION PICK WITH SCREWDRIVER GRIP
504T05	1	CARTRIDGE SEATING TOOL
504T01	1	O-RING SEATING TOOL
504T02	1	O-RING SEATING TOOL
504T03	1	O-RING SEATING TOOL
504T04	1	O-RING SEATING TOOL
504T06	1	O-RING PRESSING TOOL

1. Prep the valve body by removing the following components in order:

- Air Cylinder
- Cylinder Mount
- Grease Zerk
- #8 O-Ring Boss plug from port on opposite side of valve block

2. Using the O-Ring pressing tool (Item #7), push the old cartridge out of the valve body. Use a press if needed.

3. Remove both old teflon O-Rings from the body using the included pick (Item #1).

4. Seat the lower O-Ring.

- Place valve body on a flat table with the open #8 O-Ring Boss port facing down. Verify that the end of the valve block that has the cylinder mounting holes is facing up.
- Place the lower O-ring seating tool (Item # 4 for standard valves, Item #6 for manifold mount valves) into the cartridge hole. Verify that the top of the tool is at the bottom of the O-Ring Groove.
- Slide the O-Ring in the hole until it contacts the installation tool.
- Using the O-Ring pressing tool (Item #7), push on the O-Ring until it snaps into the groove. Use the rod to push against the O-Ring in a 360° rev. so that you know it is properly seated in the groove.
- Tip the valve body over, with the tool still inside it. The installation tool should fall through the O-Ring if the O-Ring is seated properly.

5. Seat the upper O-Ring.

- Place valve body on a flat table with the open #8 O-Ring Boss port facing down. Verify that the end of the valve block that has the cylinder mounting holes is facing up.
- Place the upper O-ring seating tool (Item # 3 for standard valves, Item #5 for manifold mount valves) into the cartridge hole. Verify that the top of the tool is at the bottom of the O-Ring Groove.
- Slide the O-Ring in the hole until it contacts the installation tool.
- Using the O-Ring pressing tool (Item #7), push on the O-Ring until it snaps into the groove. Use the rod to push against the O-Ring in a 360° rev. so that you know it is properly seated in the groove.
- Tip the valve body over, with the tool still inside it. The installation tool should fall through the O-Ring if the O-Ring is seated properly.

6. Press the new cartridge into the Body.

- Ensure that grease zerk tap in the body is aligned to the grease port in the cartridge.
- Use the cartridge seating tool (Item #2) and a press to seat the new cartridge (Do not use excessive force)

7. Reinstall components that were removed in step 1 (in reverse order).

8. Tighten nut on the end of the poppet rod until snug, then back off 1/6 of a turn (or one wrench flat) to allow the valve to operate properly.

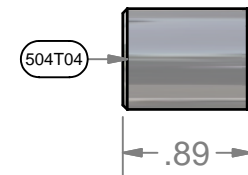
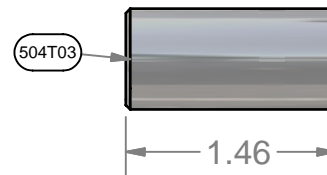
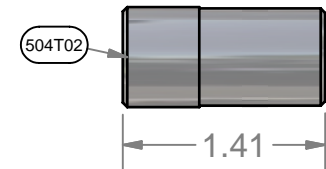
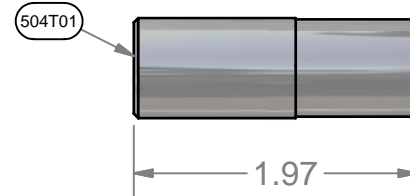

ERDMAN
Automation
Corp.



Part # 504TK1
Installation Tool Kit
For Standard & MM Teflon Valves